



Mounting instructions: Sidebar series GM/GC/BM/BC/RM/RC

# Ford Connect 2014



SW17 ( 46Nm )



SW13 ( 23Nm )



60 Min.

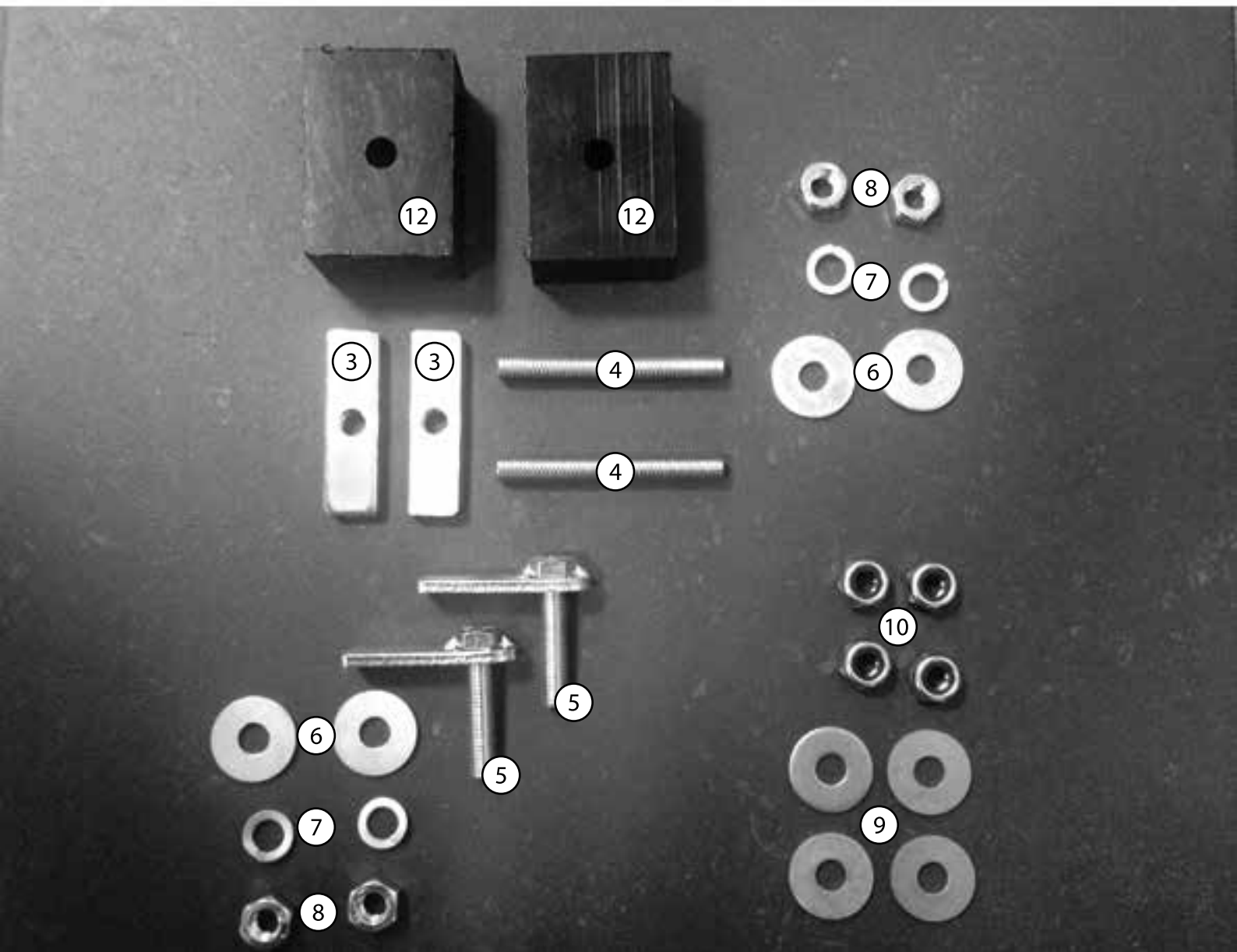
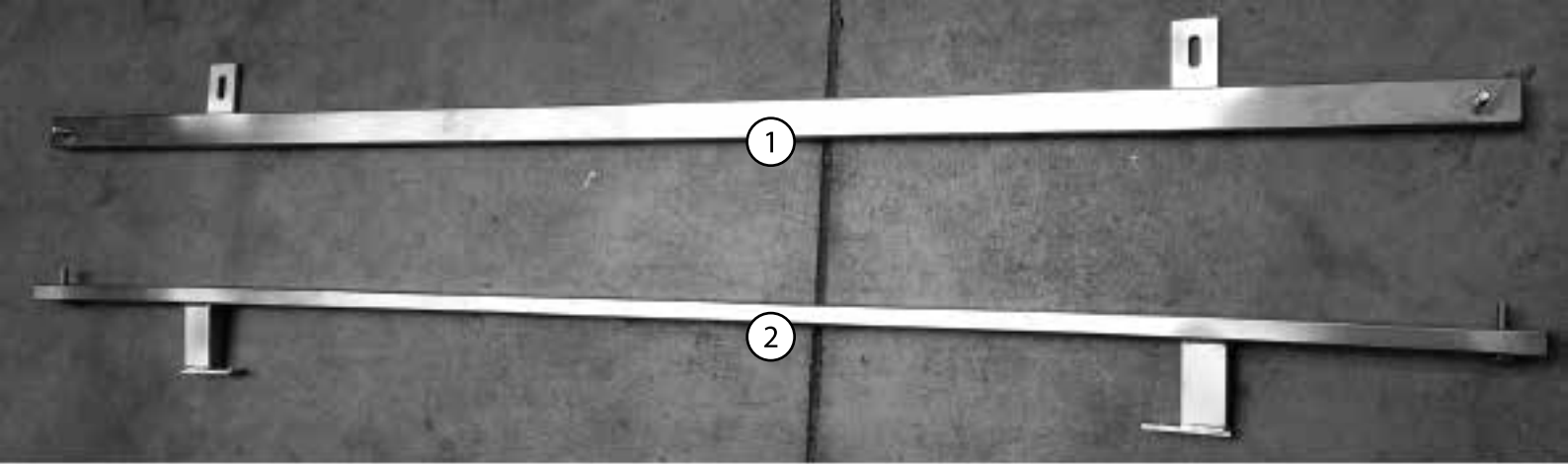

- |   |                     |    |                      |
|---|---------------------|----|----------------------|
| 1 | Front bracket       | 7  | M10 Spring-ring      |
| 2 | Rear bracket        | 8  | M10 Nut              |
| 3 | Threaded M10 plate  | 9  | M10 Stainless washer |
| 4 | Threaded rod M10x90 | 10 | M10 Stainless nut    |
| 5 | M10 Bolt hook       | 11 |                      |
| 6 | M10 Washer          | 12 | Plastic spacer       |

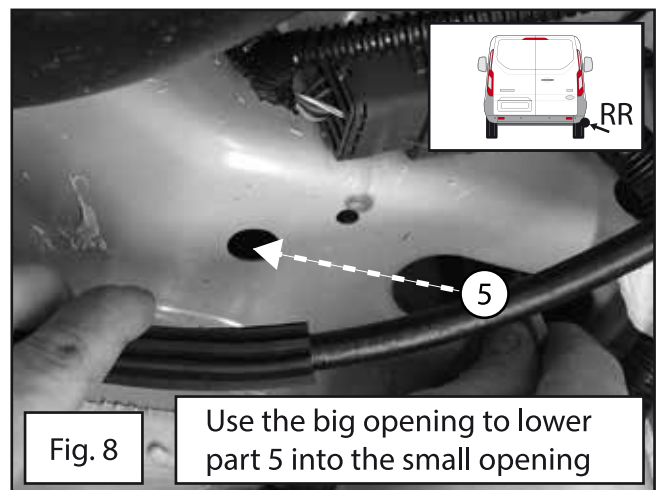
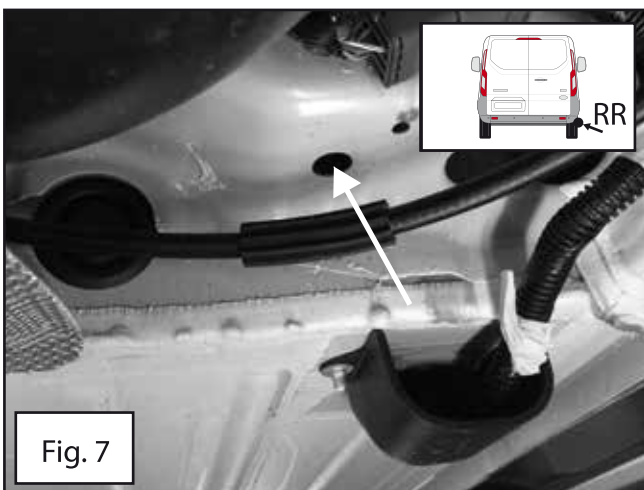
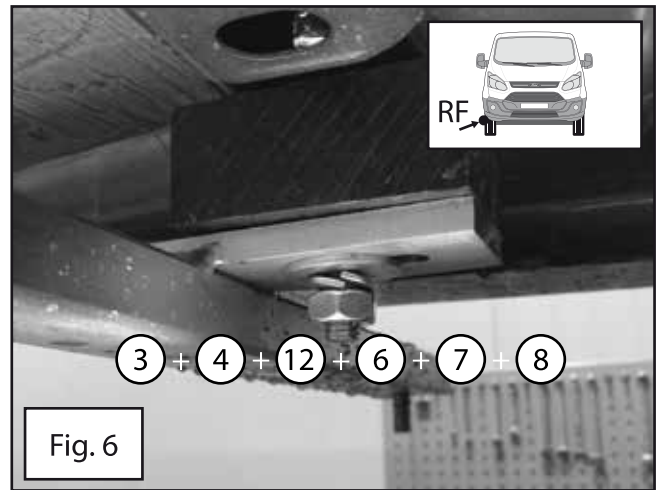
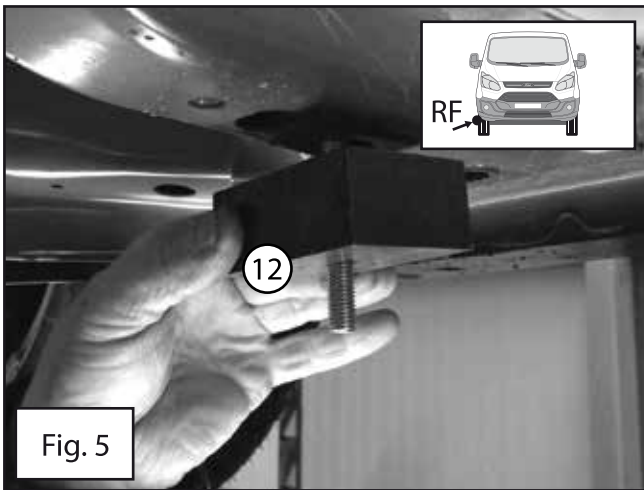
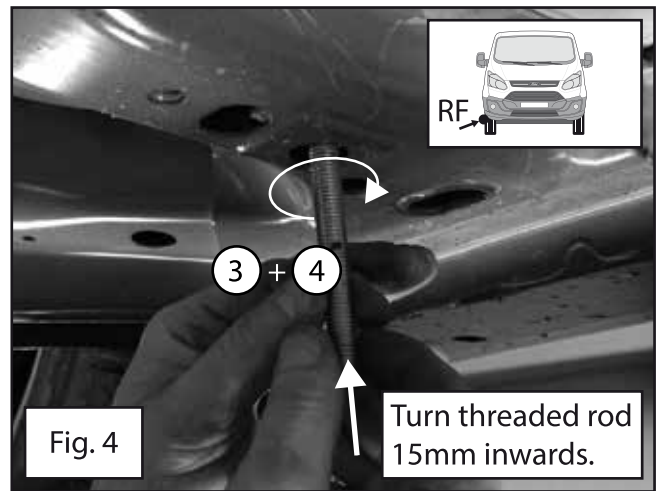
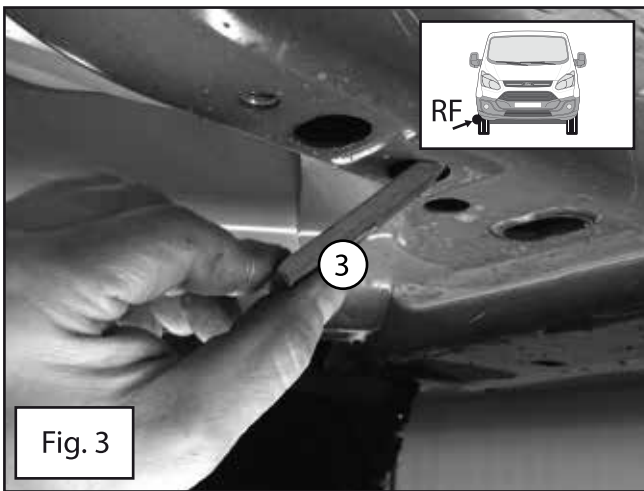
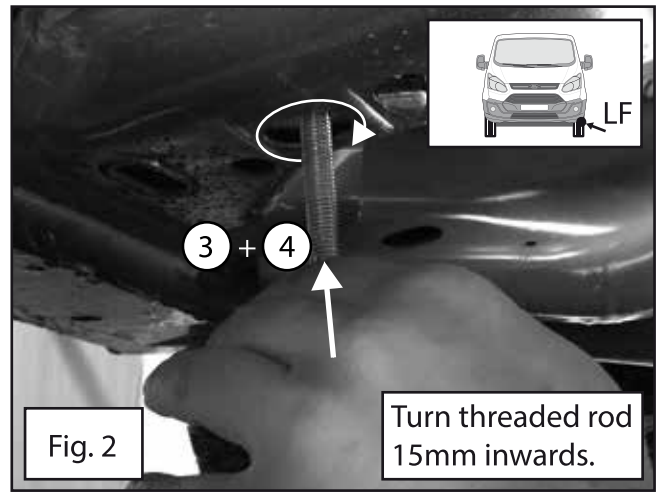
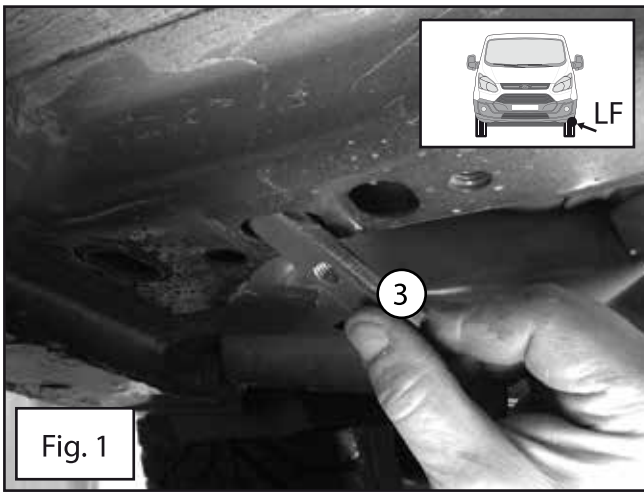

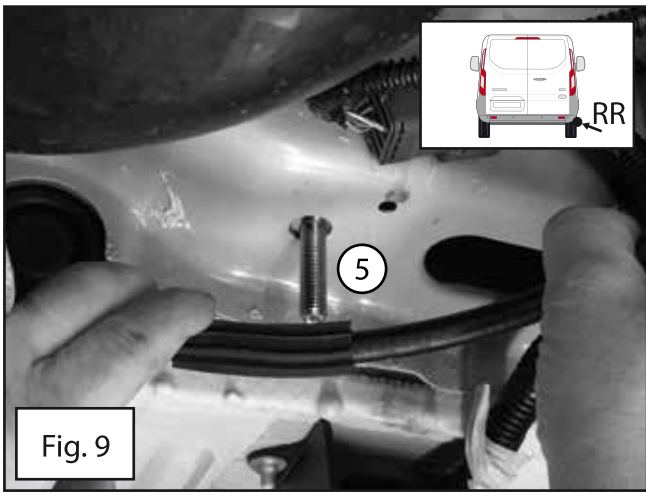

Fig. 9

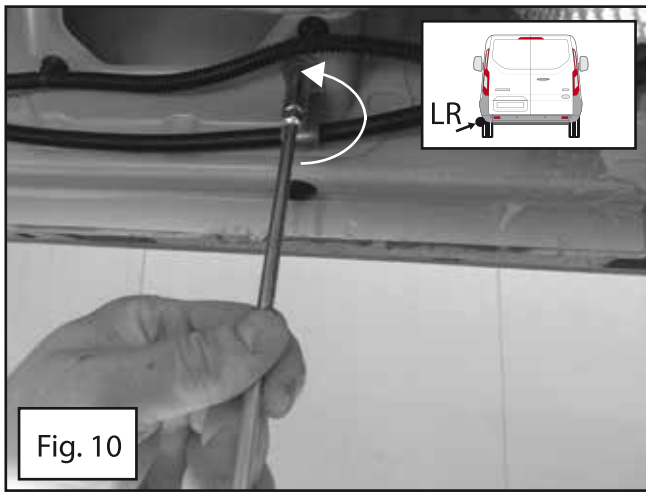

Fig. 10

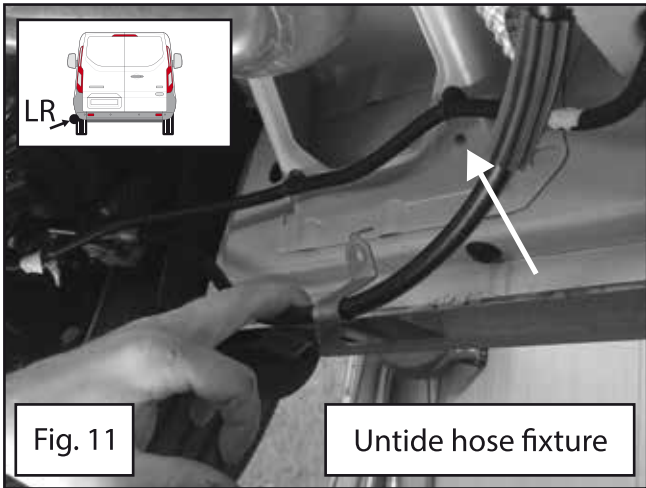

Fig. 11

Untide hose fixture

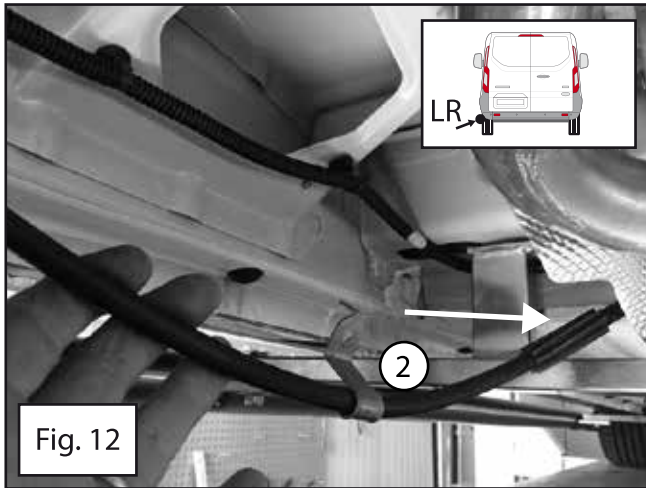

Fig. 12

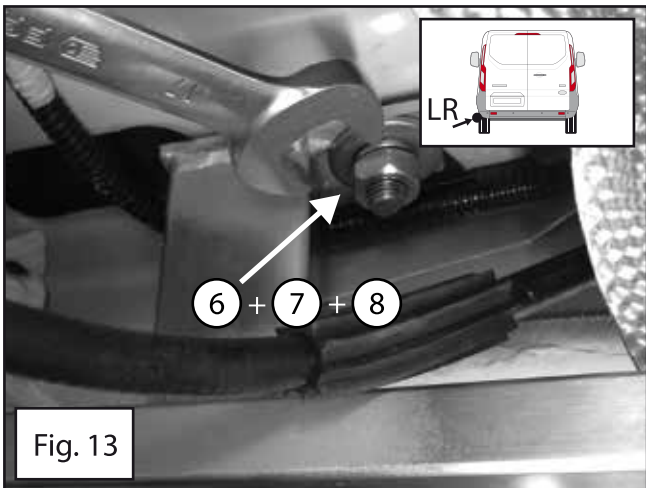

Fig. 13

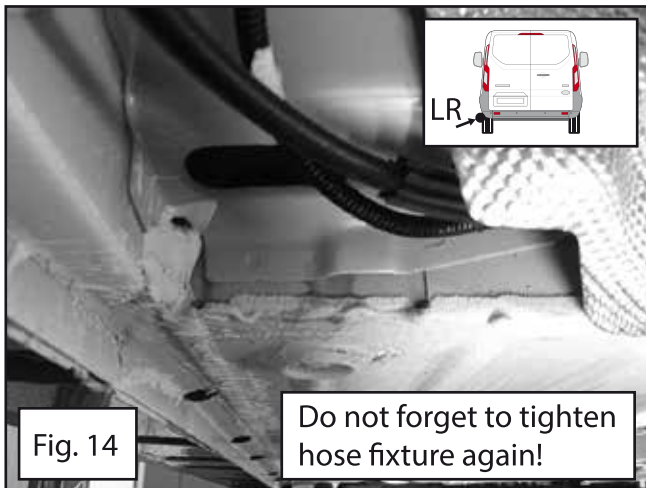

Fig. 14

Do not forget to tighten hose fixture again!

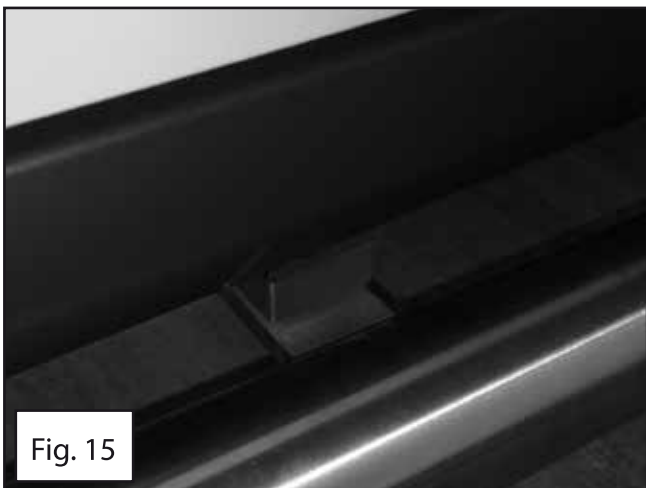

Fig. 15



Fig. 16

**ATTENTION**

Please spray all bolts and nuts with Tectyl when finished mounting. This to prevent parts from rusting and increase longevity.