

# KR36 KammRoller

## Instructions

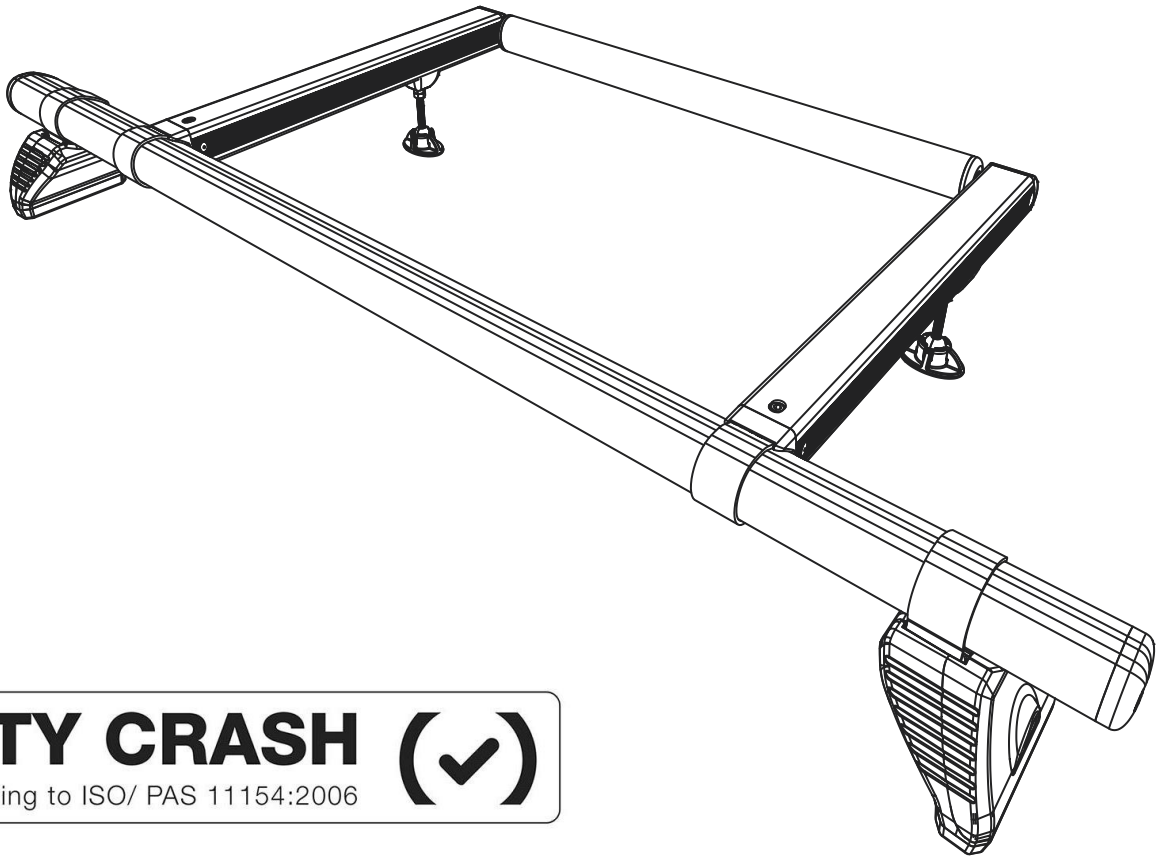

**CITY CRASH (✓)**

According to ISO/ PAS 11154:2006

**Max**  
50kg/110lbs

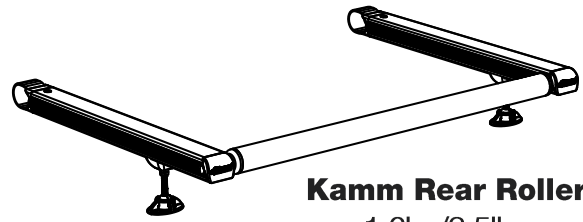
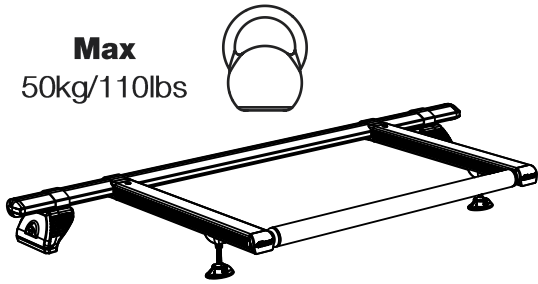

**Kamm Rear Roller**  
1.6kg/3.5lbs

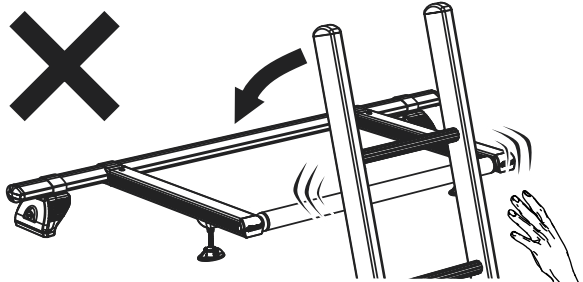
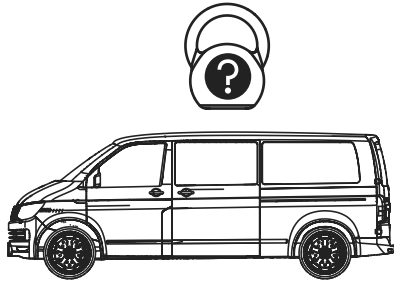

## Kamm Rear Roller

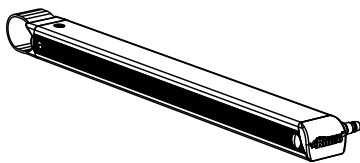

**SA414 x 1**

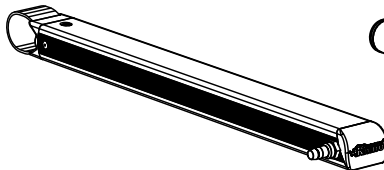

**SA415 x 1**

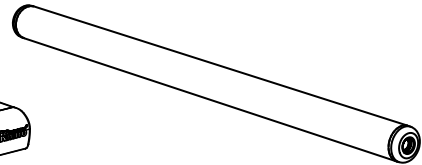

**SA403 x 1**

## Fitting Kit

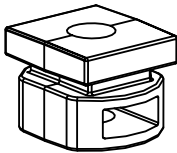

**PS201 x 2**

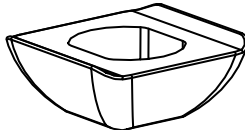

**PS202 x 2**

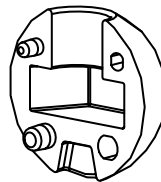

**PS203 x 4**

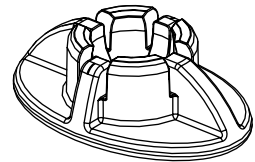

**PS204 x 2**

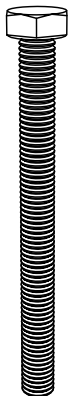

**FS109**  
**(M8 x 90) x 2**

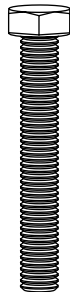

**FS105**  
**(M8 x 55) x 2**

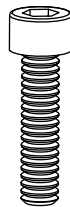

**FS103**  
**(M6 x 25) x 2**

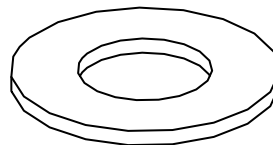

**FW021 (M8) x 2**

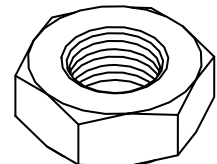

**FN039 (M8) x 6**

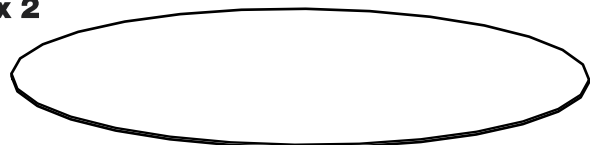

**LA074 x 2**

1.

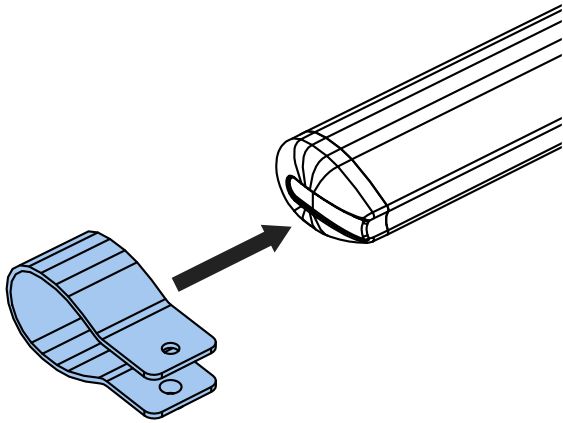

2.

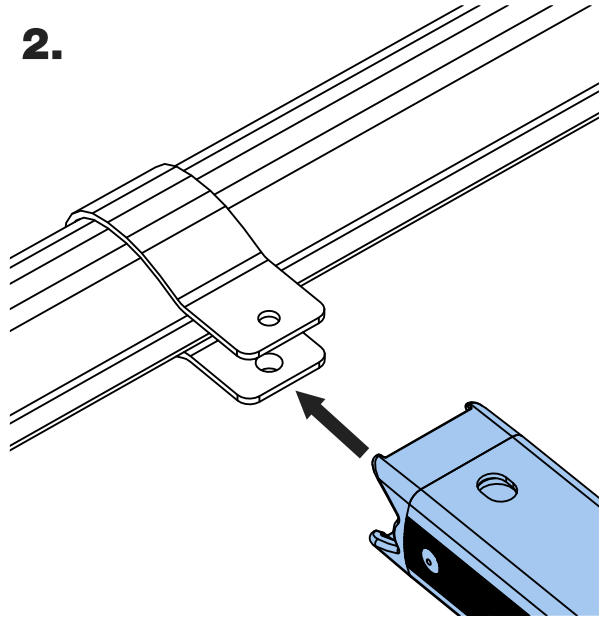

3.

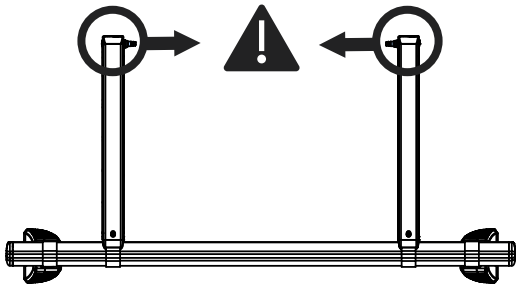

4.

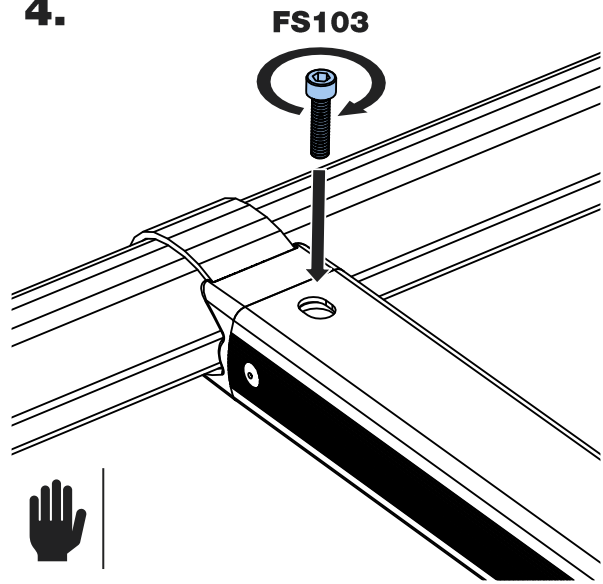

5.

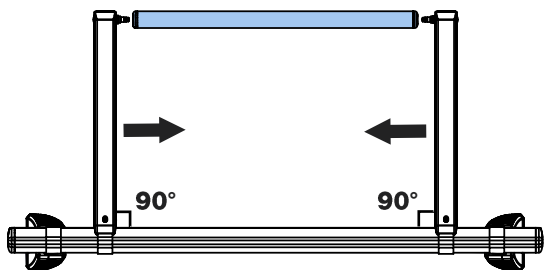

6.

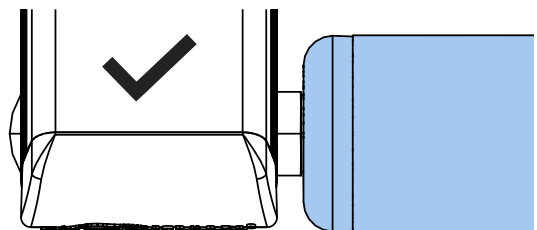
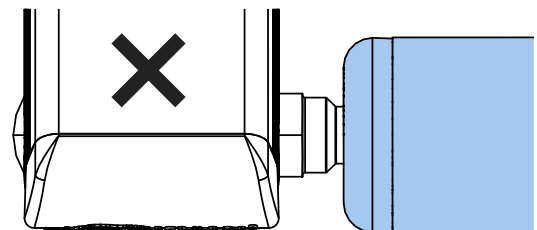

7.

48-75mm = FS105  
78-105mm = FS109

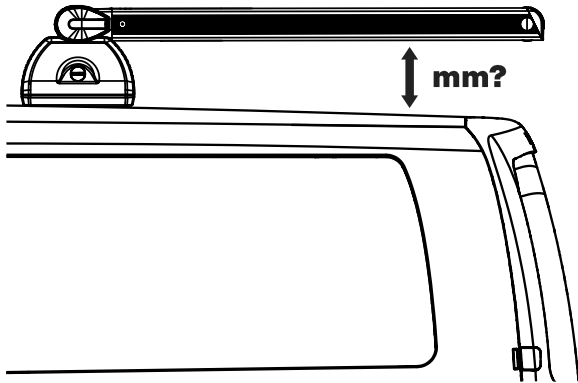

8.

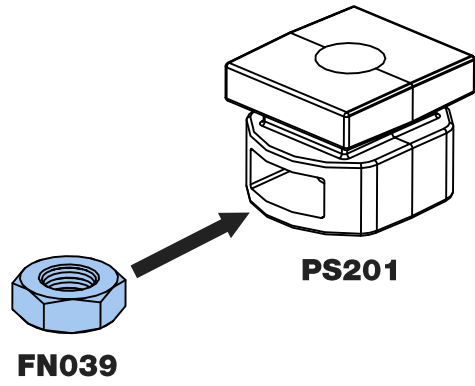

9.

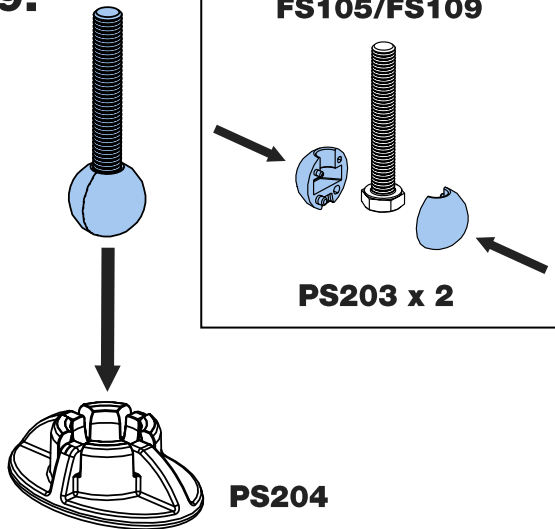

10.

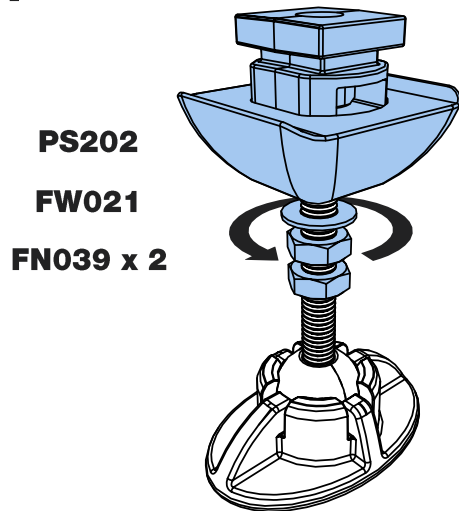

11.

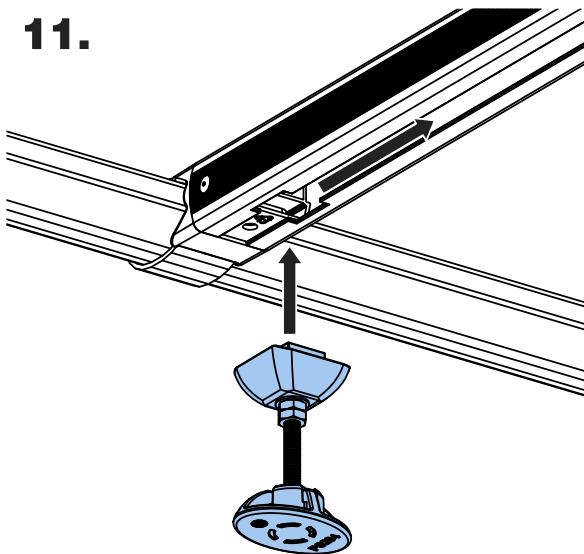

12.

